

...active in passive safety.

LIGHTING COLUMN COMPOSITE SOLUTION RESIDENTIAL



Jerol residential lighting column product family consists of five columns, 6-12M

The Column are tapered and built of two layers, the inner layer of reinforced glass fibre polyester and the outer layer of UV- resistant coloured polyolefin

The strengths of the columns are calculated according to EN 40.

The residential column is only for use in residential areas, Terrain category III in EN-40.

The estimated life of the Column is over 60 years.

The Residential Column is according to EN 12767:2000 a NE column, without compartment damage.

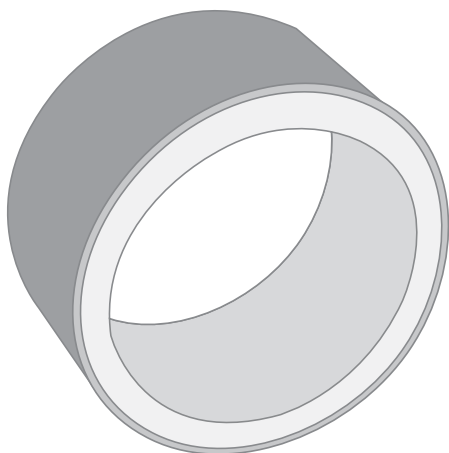

Jerol

Residential

Luminaire height 6,0m - 12m

Bracket

- Straight bracket E0
- Post top

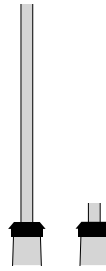

Assembly kit

AK60

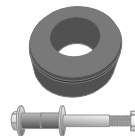

Frame, tapered



Access door

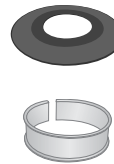

Rubber cuff

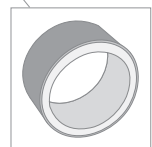

Pressure ring

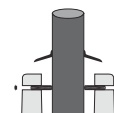

Foundation

RBJ-5B

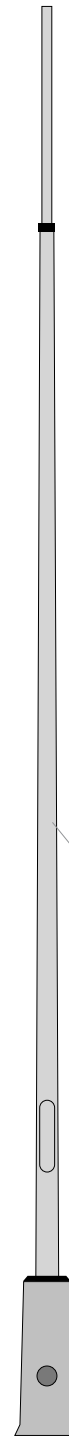
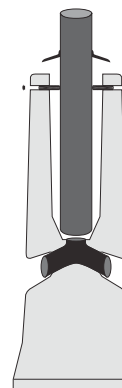

Scheme:		
Type	No.	Notes