

...active in passive safety.

SIGN POST COMPOSITE SOLUTION SAFETY



Jerol Sign Post product family consists of five posts, 114, 140, 168, 219 and 273.

The Posts are cylindrical and built of two layers, the inner layer of reinforced glass fibre polyester and the outer layer of UV-resistant coloured polyolefin.

The estimated life of the Post is over 60 years.

The Sign Posts strengths are calculated according to EN 40.

Free Sign Calculation program Jerol OPTA according to EN 12899-1.

Jerol
opta

Crash tested and approved as single and multiple legged variant according to EN 12767.

Classification: I00,NE,2, without compartment damage.

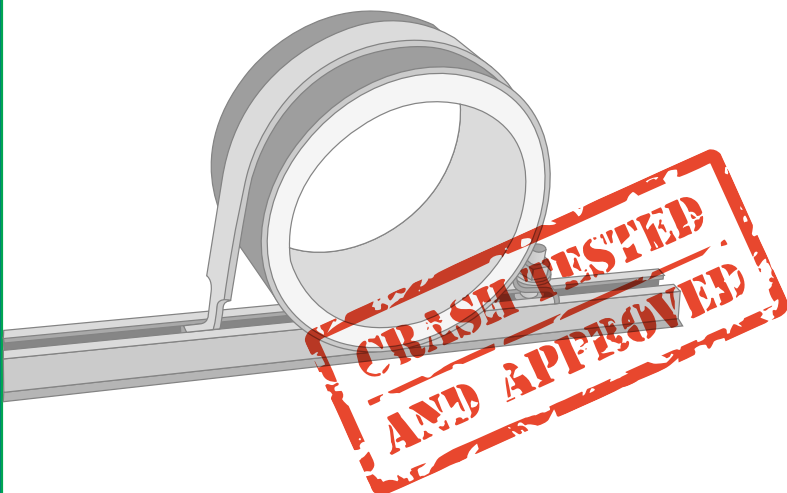

Jerol

Sign Post

Top cap

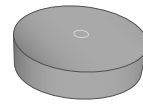

Universal clamps



Clamps for C-profile

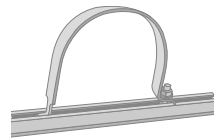

Frame, cylindrical

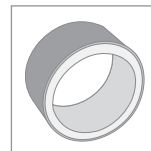

Access door

* Only in post with door opening.



Rubber cuff



Foundation

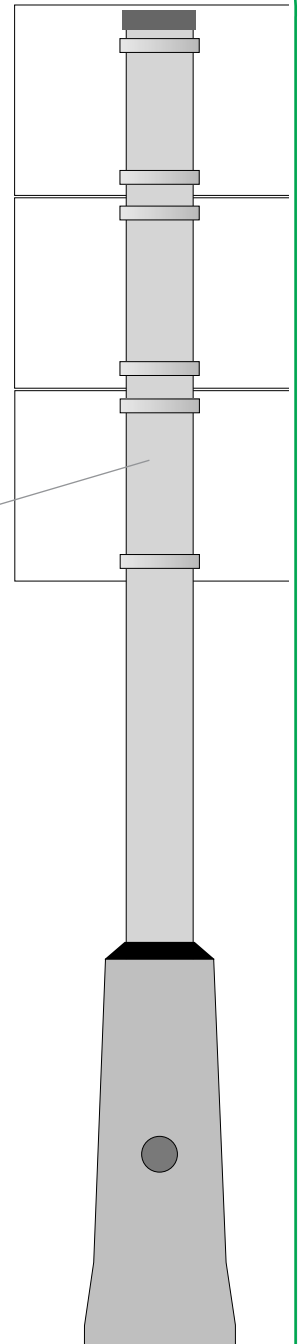

Scheme:		
Type	No.	Notes