

...active in passive safety.

LIGHTING COLUMN COMPOSITE SOLUTION SAFETY



Jerol Lighting Column product family consists of four Columns, 6M, 8M, 10M and 12M

The Columns are tapered and built of two layers, the inner layer of reinforced glass fibre polyester and the outer layer of UV-resistant coloured polyolefin.

The Columns are produced with two straps between the layers

The estimated life of the Columns is over 60 years.

The strengths of the columns are calculated according to EN 40.

Crash tested and approved as a product family according to EN 12767.

Classification: LE 70:3, NE 100: 2, without compartment damage



Jerol

6M, Safety

Luminaire height 8,0m - 12.0m

Bracket

- Single bracket E10, E15
- Straight bracket E0
- Double bracket D10, D15

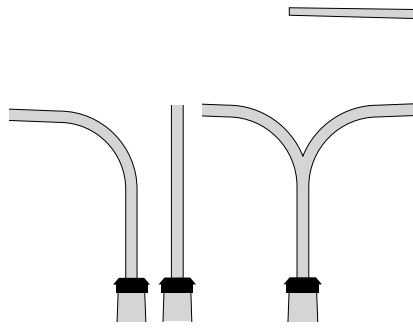

Assembly kit

AK60

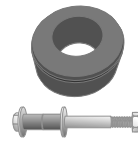

Frame, tapered



Access door

Rubber cuff

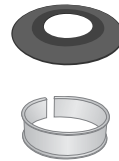

Pressure ring

Foundation

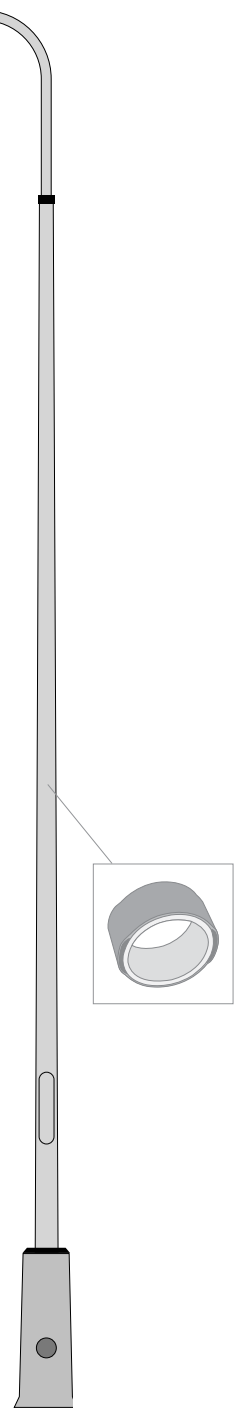
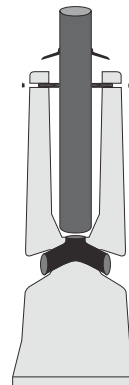

Scheme:		
Type	No.	Notes